



Installation and operating instructions for the shower enclosure MOLIER DOUBLE

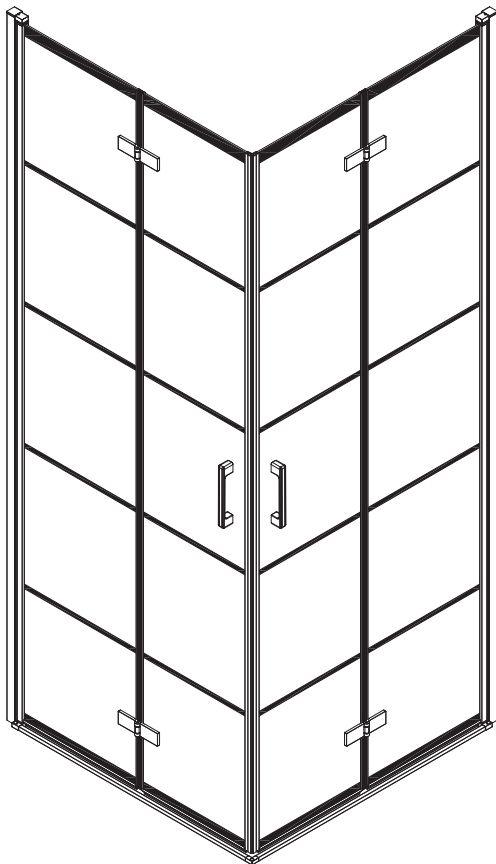

table of contents

1. Prior to installation	3
Important information	3
2. Maintenance, operation and cleaning	4
Removal of packaging and construction materials	5
Safety regulations	6
Safety precautions	6
Additional information	6
3. Assembly Instructions	7
Required tools	7
installation of shower enclosure	8

1 Prior to installation

Read the instructions carefully before starting to assemble the enclosure. The diagrams included in the instructions are for illustrative purposes only. Any discrepancies between the appearance of the enclosure components do not qualify for a warranty claim.

ATTENTION: If you attempt to assemble the shower enclosure on your own, please note that the plumbing installation and any electrical connections should be made by qualified professionals in accordance with current safety standards and regulations. **For proper installation requires min. 2 people.**

The enclosure must not contain electrical, gas, etc. equipment that is not resistant to direct contact with water (e.g. electrical switches, sockets).

Any electrical or gas equipment in the vicinity of the intended installation site must be at a safe distance from the enclosure structure. A jet of water escaping from the enclosure may result in a short circuit in the electrical system, for example.

The foundation on which the unit will be placed must provide stability. The walls must have an upright slope to ensure proper grip of the bearing wall structure.

2 Maintenance, operation and cleaning

Careful maintenance of all parts of the shower enclosure should be done systematically. Carefully follow the recommendations given here to maintain the gloss of the acrylic and metal parts.

All structural parts of the enclosure, i.e. glass, painted parts, acrylic and plastic parts, should be cleaned with mild, non-abrasive detergents using a soft cloth. The use of abrasive pastes, solvents, acetone, detergents containing chlorine, etc. should be avoided.

Do not use sharp sponges, brushes with metal wires, powder and liquid cleaners containing abrasive substances or ammonia, acetone or other solvents, as they damage surfaces. Do not use any corrosive cleaning agents because they can be harmful to health and cause damage to the product. Substances containing acids, alkaline polishes, nylon brushes, sandpaper can be bad for health and can damage the shower enclosure. Lime scale should be removed with citric acid or vinegar dissolved in water using a soft cloth.

It is recommended to install a water softening device to avoid limescale deposits.

Ammonia-free window cleaners are recommended for cleaning windows and mirrors.

Elements should be cleaned systematically, at least 3 times a month or more often if necessary.

- Chrome or gold-plated components do not require too much polishing.
- Do not use knives or other sharp tools to clean the cab.
- Drain the water immediately after bathing, then clean the cabin.
- The manufacturer is not responsible for damage resulting from improper use, installation or care of the product.
- The manufacturer reserves the right to make changes to the design of the product.
- Make sure the roller tracks holding the door are free of dirt.
- Children and people with disabilities should not be left unattended in the enclosure.
- Do not lean objects against the shower enclosure door which may scratch or damage the glass of the shower enclosure.
- There must be a maximum of one person in the enclosure.
- Do not hit, push or otherwise inappropriately force the glass or profiles of the shower enclosure.

Removal of packaging and construction materials

Materials made from cardboard are recyclable. The adhesive tape and protective film should be recycled. Non-recyclable packaging components must be disposed of safely and in accordance with current waste legislation. Recyclable components (glass, aluminium) should be recycled after the product has been discarded.

Safety regulations

The manufacturer is not liable in the following cases:

- in the event of non-compliance with the provisions contained in the standards for residential electrical installations,
- if the installation and maintenance instructions in this manual are not followed,

Please read the entire manual carefully before using the appliance. Keep this manual for future reference or to pass on to a future user. The manual has been compiled for different models and versions, therefore the appearance of the product may differ from the examples shown in the diagrams and photos. However, the instructions are not subject to change.

The manufacturer reserves the right to make any changes, without any obligation of prior notice or replacement. This product may only be used in accordance with its intended use. The manufacturer is not responsible for damage caused by improper use of the product.

Safety precautions

When storing the product, do not tip it over or stack other packages on top of it. It should not be stored together with organic solvents such as formalin. When transporting the product packaging should be lifted and lowered carefully and avoid impacts, stresses, shocks etc. If the cabin is to remain unused for a long period of time, it should be dried and ventilated.

Additional information

Use mould-resistant sanitary silicone to seal the cabin connections.

3 Assembly Instructions

Assembly notes

Before starting assembly, please check that all components included in the instructions are in the packaging and that they are not damaged. In case of damage or shortages, please contact your dealer urgently.

ATTENTION: DO NOT INSTALL DAMAGED COMPONENTS

- a) Please read the instructions before starting assembly, check that you have the required tools and components for the enclosure. Follow the instructions.
- b) Please do not use sharp or hard objects during installation to avoid damaging the glass. If necessary, use a rubber tap hammer.

Required tools

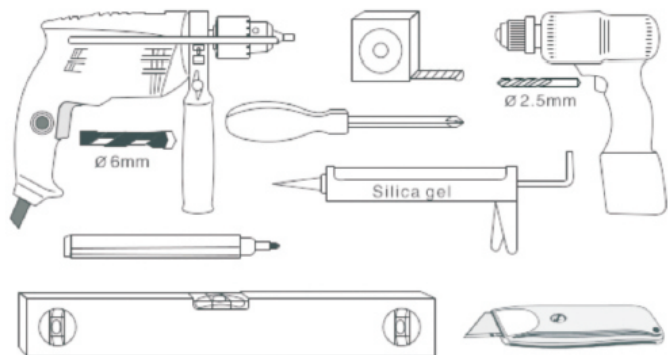

ATTENTION:

1. People who feel weak or under the influence of alcohol should not use the enclosure.
2. People suffering from heart disease and high blood pressure should be particularly careful when using the shower enclosure.
3. Children and the elderly must use the enclosure under adult supervision.
4. Please take extra care when entering and leaving the enclosure. To avoid damage to the cabin and loss of balance please do not lean against the wall.
5. Please adjust the bathing time to your well-being.
6. It is forbidden to turn on only hot water while adjusting the water temperature.
7. Smoking is prohibited in the cabin.

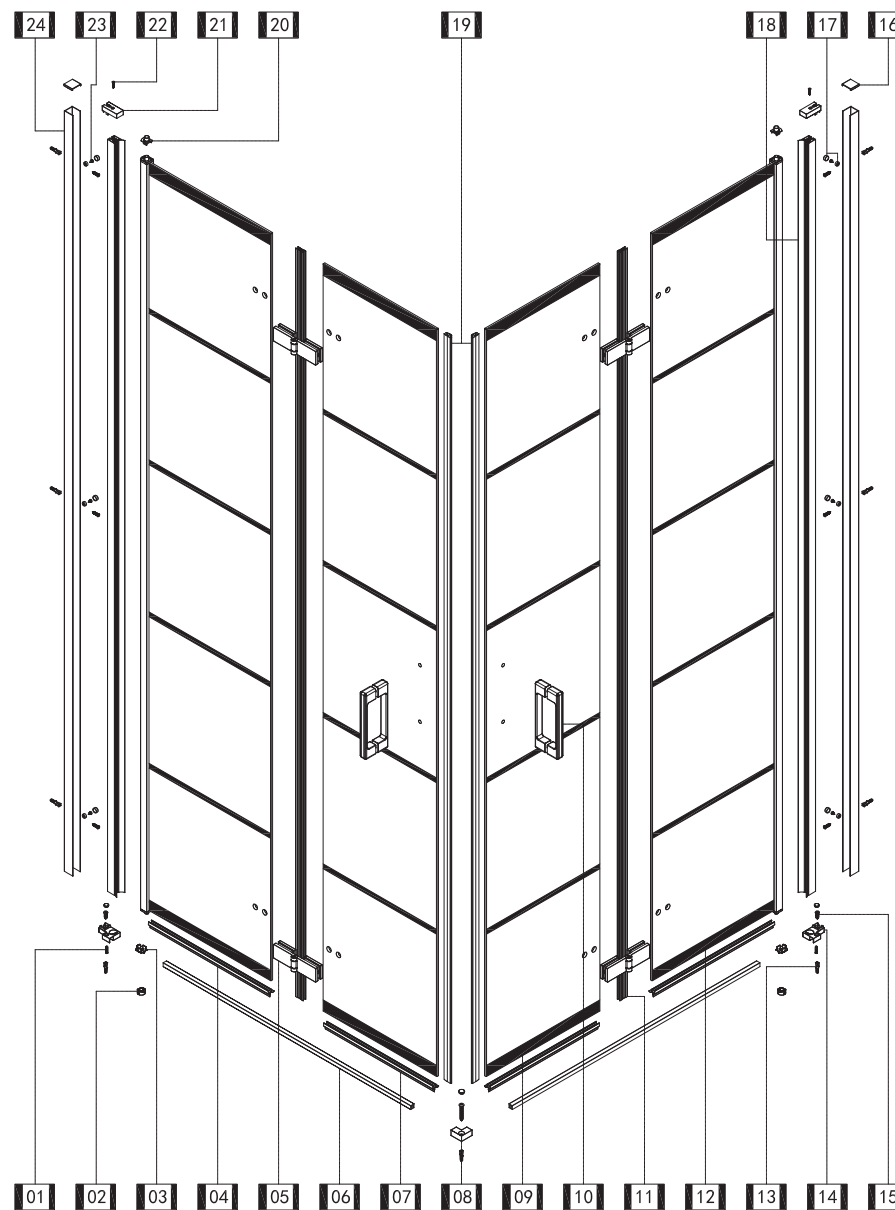

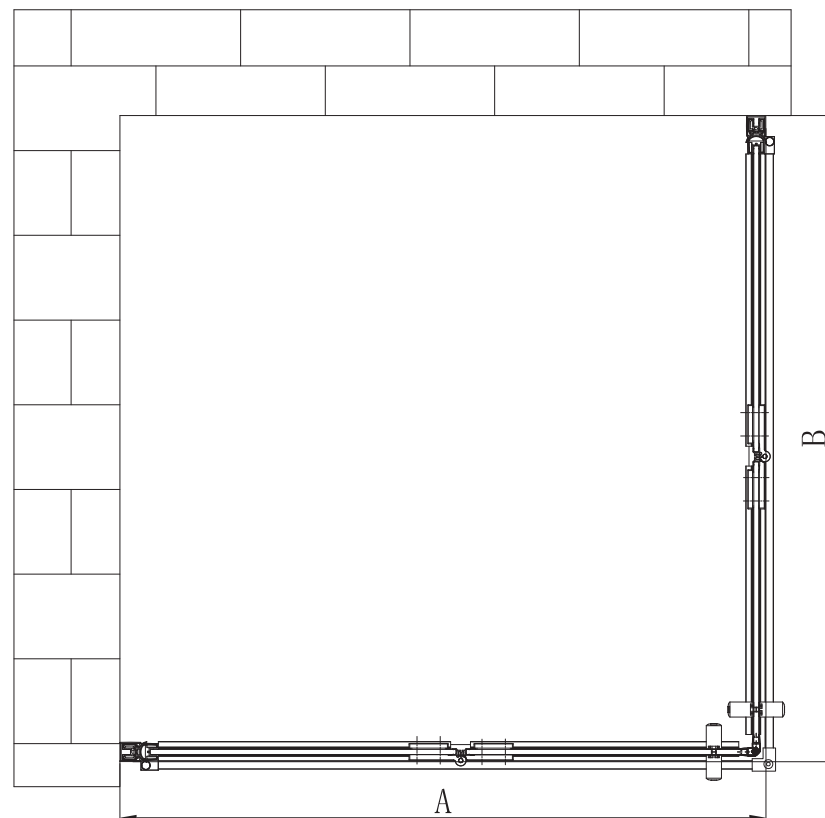
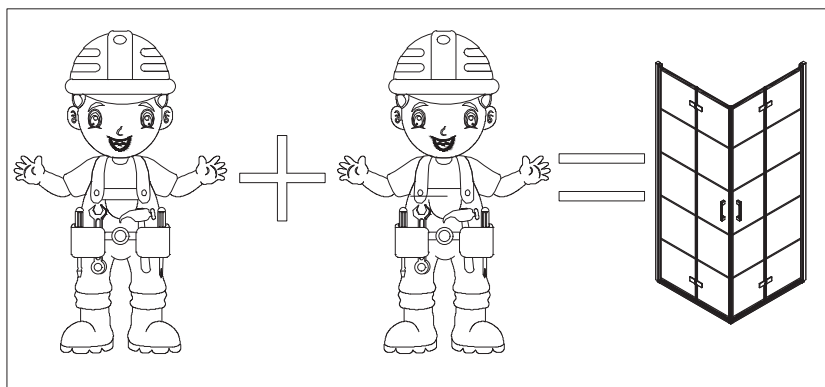
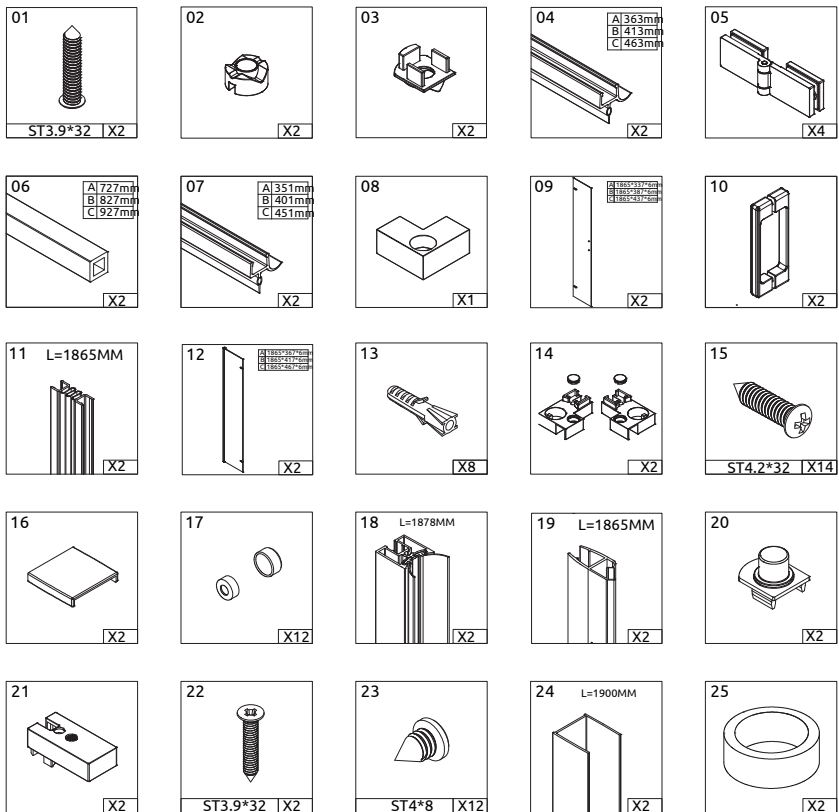

(A)	(B)
775~785	775~785
875~885	875~885
975~985	975~985

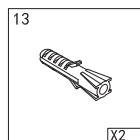
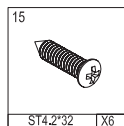
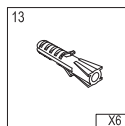
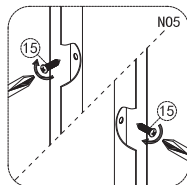
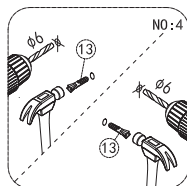
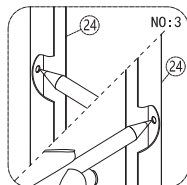
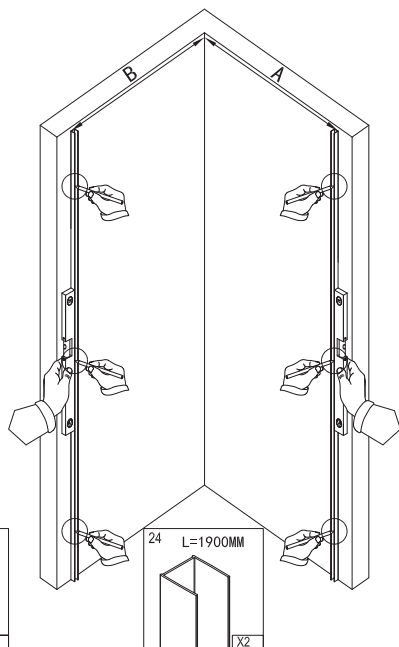
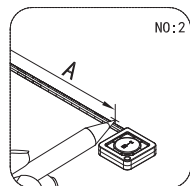
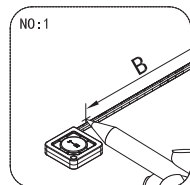

NO1 - Measure dimension 'B'.

NO2 - Measure dimension 'A'.

NO3 - Mark the locations for the holes by applying the wall profiles (24) at the marked locations.

NO4 - Drill the holes and insert the wall plugs (13).

NO5 - Screw the wall profiles (24) with the screws (15).

NO:1 - Place element 14 in the wall profile (24).

NO:2 - Determine the position for the mounting hole.

NO:3 - Remove element 14 from the wall profile.

NO:4 - Drill the hole and place the wall plug (13) in it.

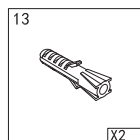
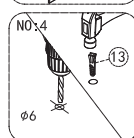
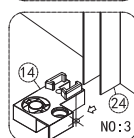
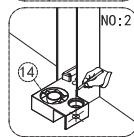
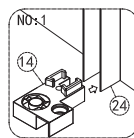
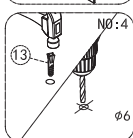
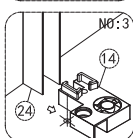
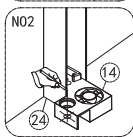
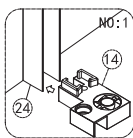

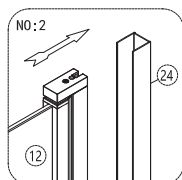
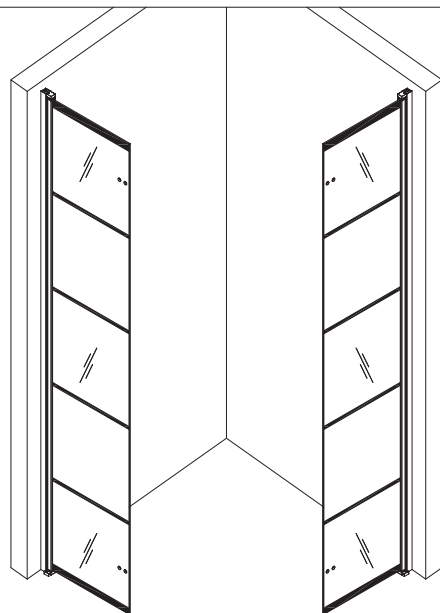
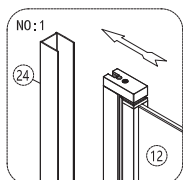
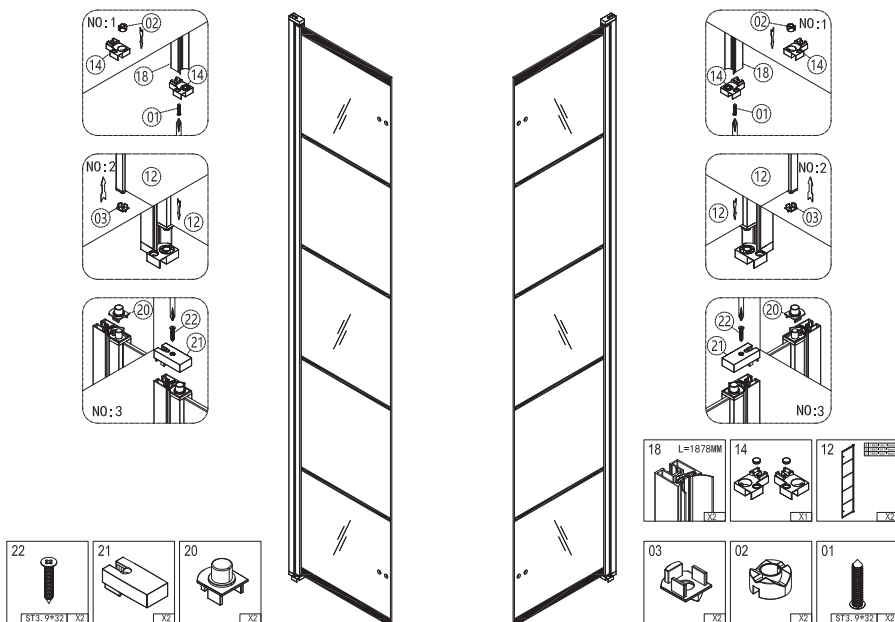

NO:1 - Connect element 02 to element 14 and screw them to the vertical profile (18) with screw (01).

NO:2 - Insert element 03 at the bottom of the glass with profile (12). Insert the glass with profile (12) onto element 14.

NO:3 - Put element 20 on top of the glass with profile (12), then connect the glass (12) and the profile (18) with element 21 and screw (22).

NO1 - Place the glass (12) in the wall profile (24).

NO2 - Repeat on the opposite side.

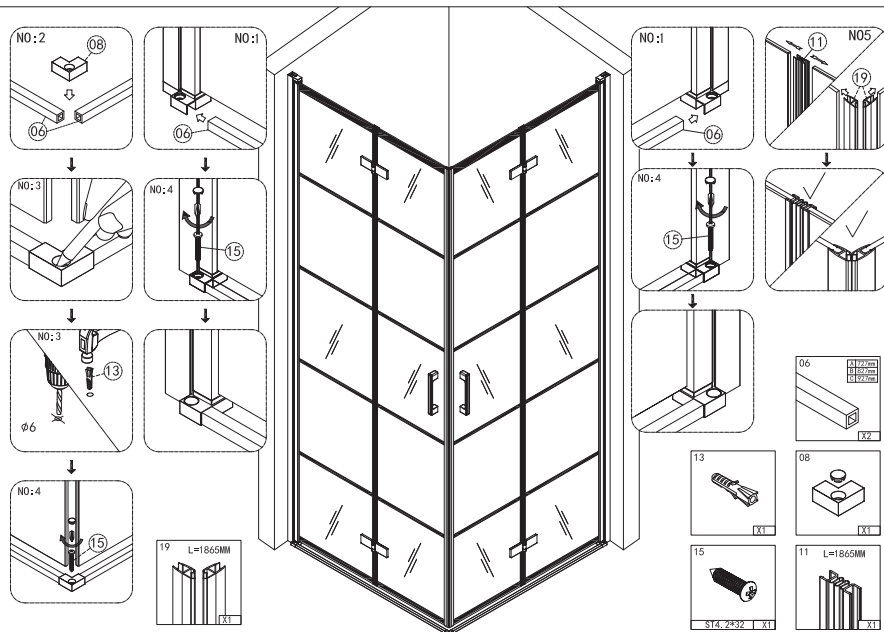
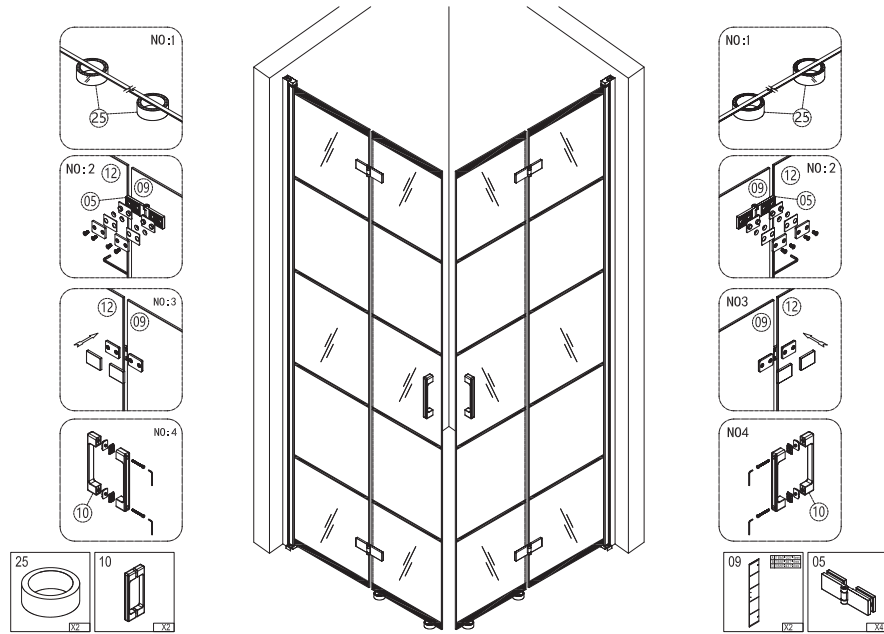

NO1 - Place the door glass (09) on the washers (25).

NO2 - Connect the panes (09, 12) with the hinges (05).

NO3 - Place the caps on the hinges.

NO4 - Screw the handle (10) to the door glass (09).

NO1 - Slide the sill strips (06) into the connectors (14).

NO2 - Place the corner connector (08) on the sill strips (06).

NO3 - Determine the location for the mounting hole of the corner connector (08), drill a hole and place a dowel pin (13) in the hole.

NO4 - Screw the fasteners (08, 14) with screws (15) and attach the caps.

NO5 - Fit the inter-pane seals (11) between the panes (09, 12) and the magnetic seals (19) on the door panes (09).

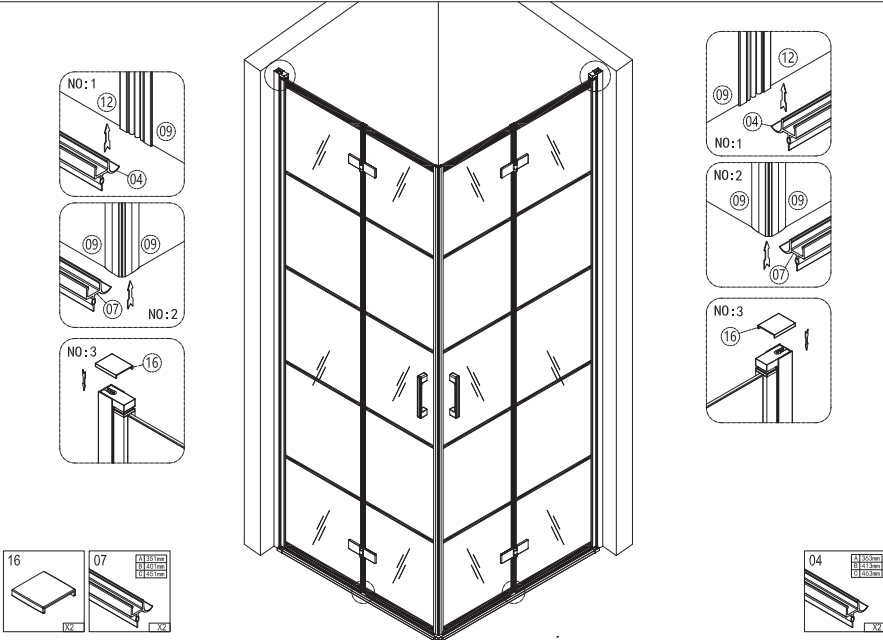
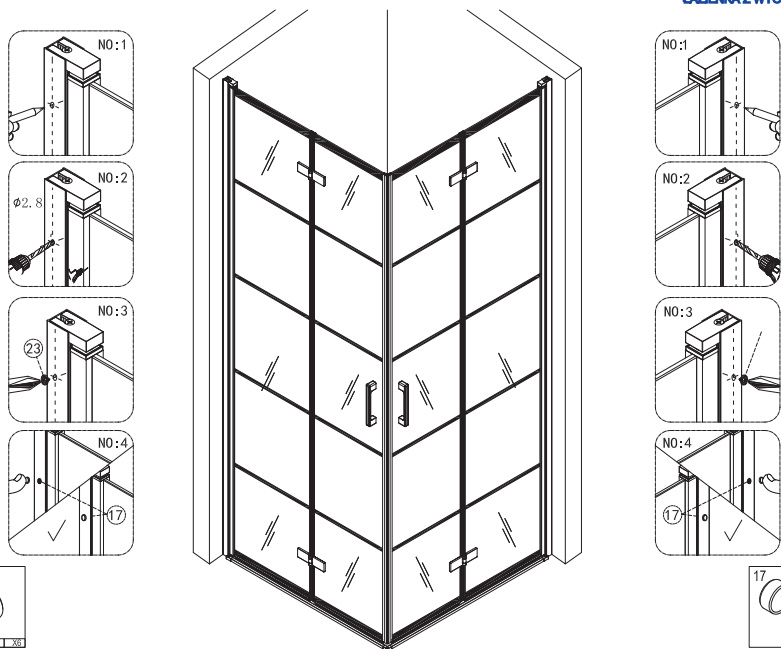

NO1 - Make sure the door is properly aligned on the wall profiles and mark out the locations for the holes .

NO2 - Drill the mounting holes in the wall profiles.

NO3 - Screw the profiles together using washers (17) and screws (23).

NO4 - Place the caps (17) on the screws(23).

NO1 - Place the bottom seals (04) on the glass panes with the profile (12).

NO2 - Place the bottom seals (07) on the door panes (09).

NO3 - Place caps (16) on the wall profiles (24).

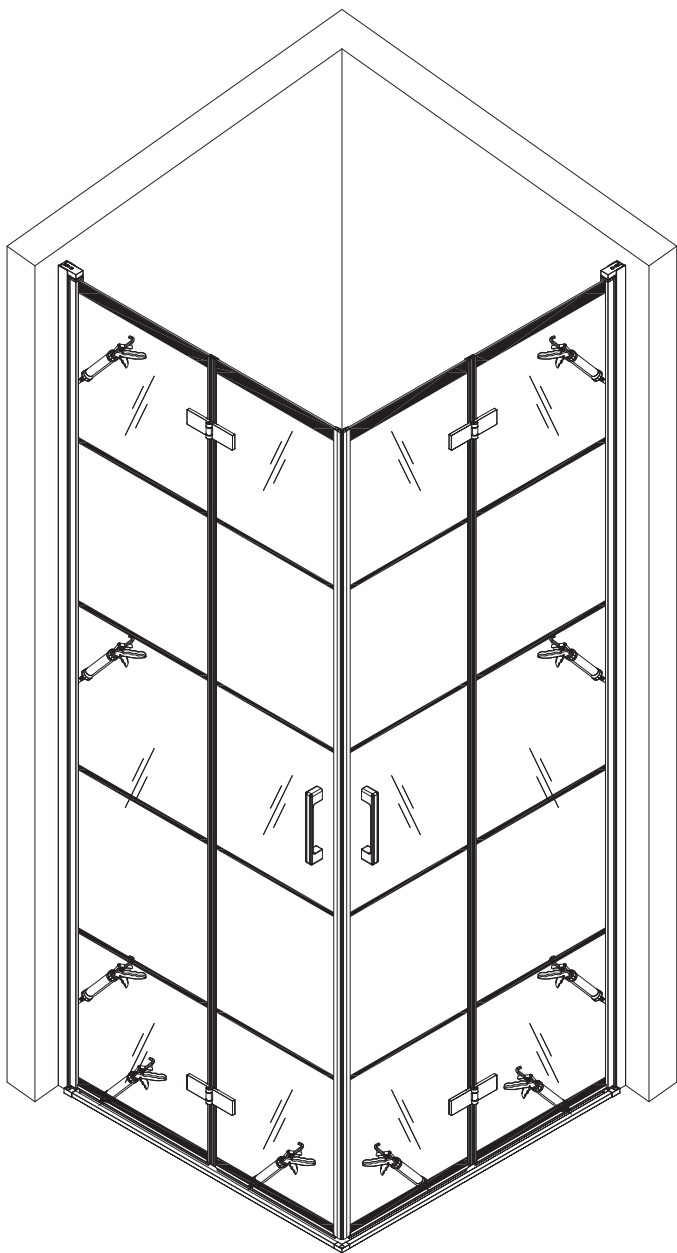

Secure all immovable joints with sanitary silicone. Leave the joints to dry for 24 h.